

REACH & RoHS COMPLIANT

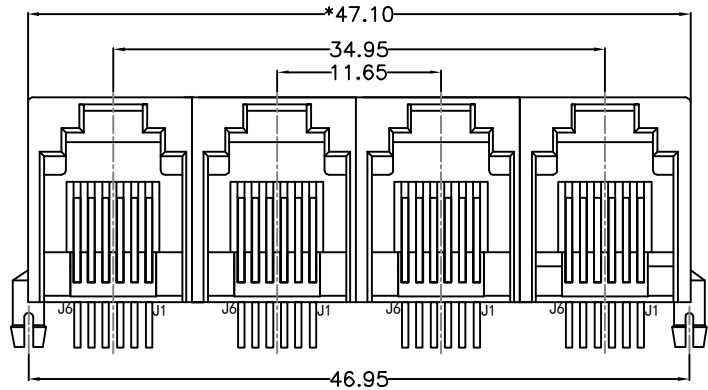

FRONT VIEW

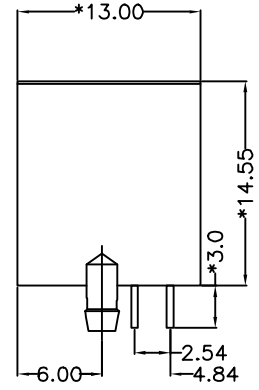

RIGHT SIDE VIEW

MATERIAL:
 HOUSING: PBT,UL94V-0,BLACK.
 TERMINAL: PHOSPHOR BRONZE Ø=0.46MM, G/FU" GOLD PLATING.

MACHANICAL:
 DURABILITY: 750 CYCLES MIN,12.5MM/MINUTE.
 INSERTION FORCE: 2.2KG.F MAX.
 RETENTION STRENGTH : 7.7KG.F BETWEEN JACK AND PLUG.
 OPERATING TEMPERATURE: -40°C~+85°C.
 STORAGE TEMPERATURE: -40°C~+85°C.
 ALL CRITICAL DIMENSIONS WITH ""

ELECTRICAL:
 VOLTAGE: 125 VOLTS AC.
 CURRENT RATING : 1.5AMP.
 DIELECTRIC STRENGTH: 1000 VAC RMS 50HZ OR 60HZ,1MIN.
 INSULATION RESISTANCE: 500 MEGA OHMS MIN. INITIAL
 AFTER 500V DC FOR 1 MINUTE.
 CONTACT RESISTANCE: SINGLE TERMINAL 30 MILLIOHMS MAX.
 INITIAL 50 MILLIOHMS MAX. AFTER
 DURABILITY TEST.

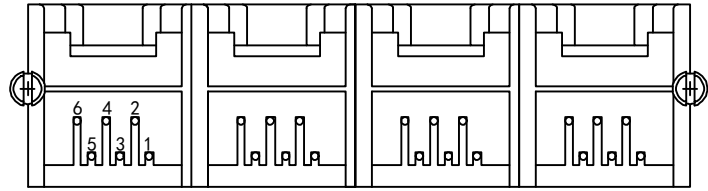

BOTTOM VIEW

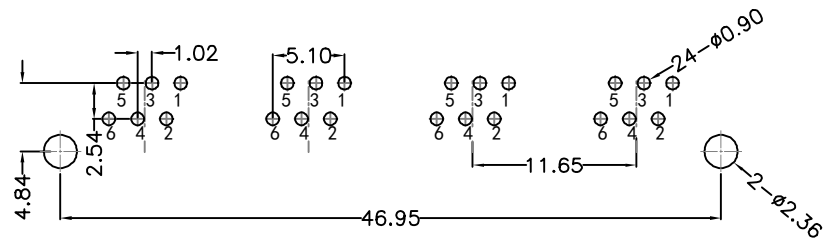

RECOMMENDED PCB LAYOUT
 VIEWED FROM COMPONENT SIDE

VOOHU 苏州沃虎电子科技有限公司
 Su Zhou Voohu Electronic Tech.Co.Ltd

TITLE:
 RJ11 5521 1X4 6P6C

SIZE
 A4

UNITS
 MM[INCH]

GENERAL TOLERANCES
 UNLESS SPECIFIED

PART NO.:
 SYT55211466IWA1DY1017

SACLE
 1:1

REV
 A0

APPROVED BY:
 Geoffrey.Song

REMARK:

SHEET
 1/1

APPROVED BY:
 Sunny.Xu

TEL: +86 400 1048 018

WEB: WWW.WOHU-TEK.COM

CHECKED BY:
 Elvis.Song

DESIGND BY:
 Sunny.Xu